

Z  
Y  
X  
W  
V  
U  
T  
S  
R  
Q  
P  
O  
N  
M  
L  
K  
J  
I  
H  
G  
F  
E  
D  
C  
B  
A

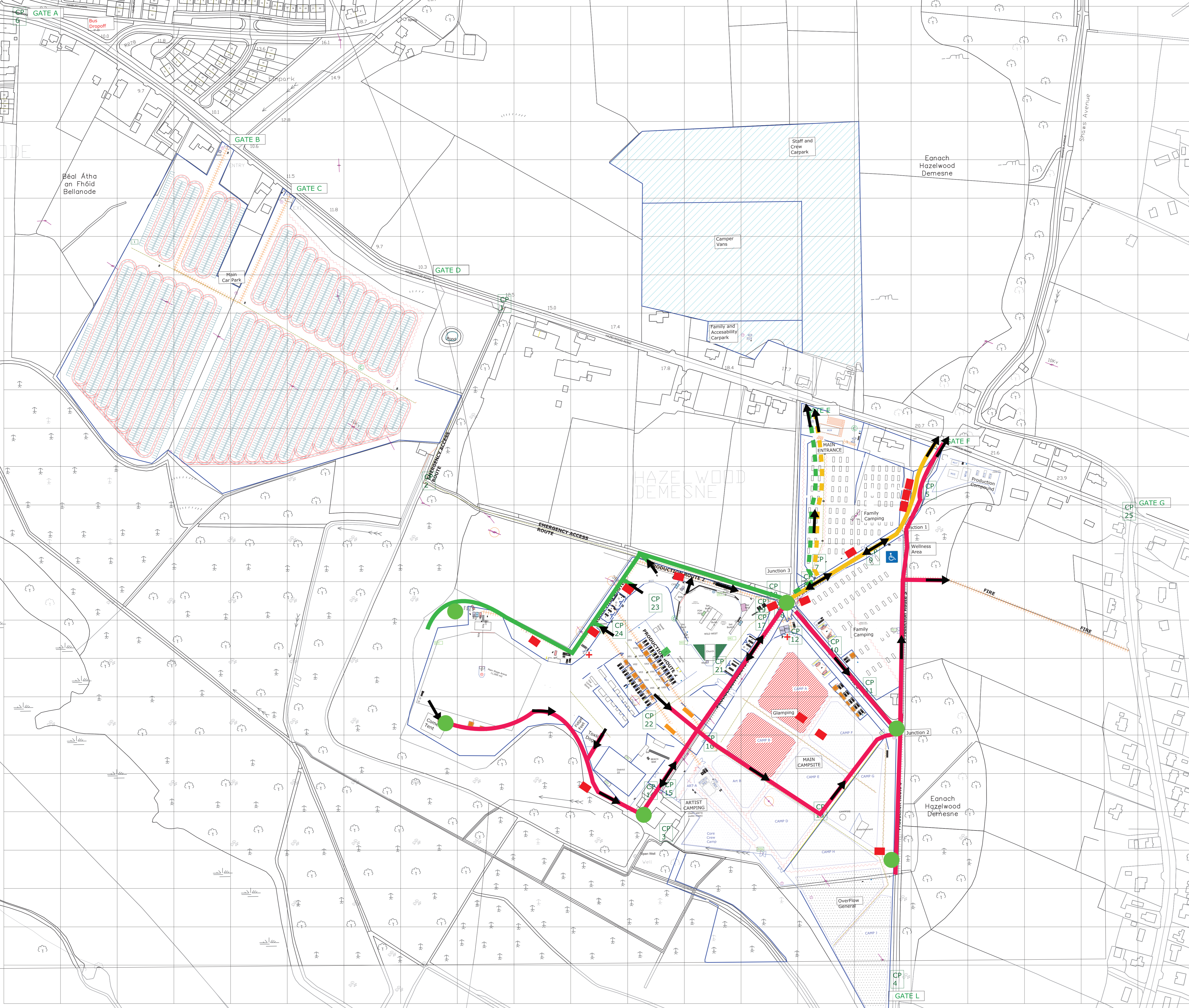

1 2 3 4 5 6 7 8 9 10 11 12 13 14 15 16 17 18 19 20

**Legend**

- Herreris Fencing
  - + First Aid
  - CP Control Point
  - IBC
  - Vehicle Trackway
  - Tappit Top Up (no. in top corner)
  - Watch Tower
  - Camera Position
  - Festoon
- Toilets**
- Toilet
  - Vendor & Bar Toilets
  - Staff & Performer Toilets
  - Public Toilets
- Gas, Lighting, Generators**
- Gas
  - Generators
  - Lighting Towers
  - Work Lighting
- Traders**
- Bars
  - Food & Beverage Vendors
  - Stalls
- Waste Management**
- Glass BOH
  - Waste Compound
  - X3 Bin Station
  - X2 Bin Station
- Showers & IBCs**
- Shower Blocks
  - Bath
  - IBC's (Grey Water)
- Water**
- Staff & Performers
  - Vendor / Bar
  - Bottled
  - Public
- Gates**
- Production Security Gate (Needs Person)
  - Wristband Checkpoint (Needs Person)
  - Emergency Exit
  - Gate
- Marquees**
- 1 First Aid Post 3x6m Floored
  - 2 First Aid Post 6x9m Floored
  - 3 Welfare 9x6m Floored
  - 4 Event Control 9x6 Floored w/soft dividers at 3m
  - 5 Staff Canteen 10x15m Floored
  - 6 Tech Production 3x6m Floored
  - 7 Strip Search 3x3m Floored
  - 8 Wristband 9x24m no Floor
  - 9 Security HQ 3x3m Floored
  - 10 Volunteer HQ 9x6 Floored
  - 11 Artist (2) 12x3m
  - 12 Artist (1) 12x3m
  - 13 Green Room 3x6m Floored
  - 14 Hacienda 9x6m Floored
- Pedestrian Emergency Egress**
- Egress Route A (Alternate)
  - Egress Route B (Alternate)
  - Egress Route C (Alternate)
- Heavy Vehicle Emergency Egress**
- Egress Route A (Alternate)
  - Egress Route B (Alternate)
  - Egress Route C (Alternate)
  - Turning Circle
  - Lay-by
  - Two Way
  - One Way
- Internal Traffic**
- Internal Roadway
  - Light Vehicle Access
- Public Walkways**