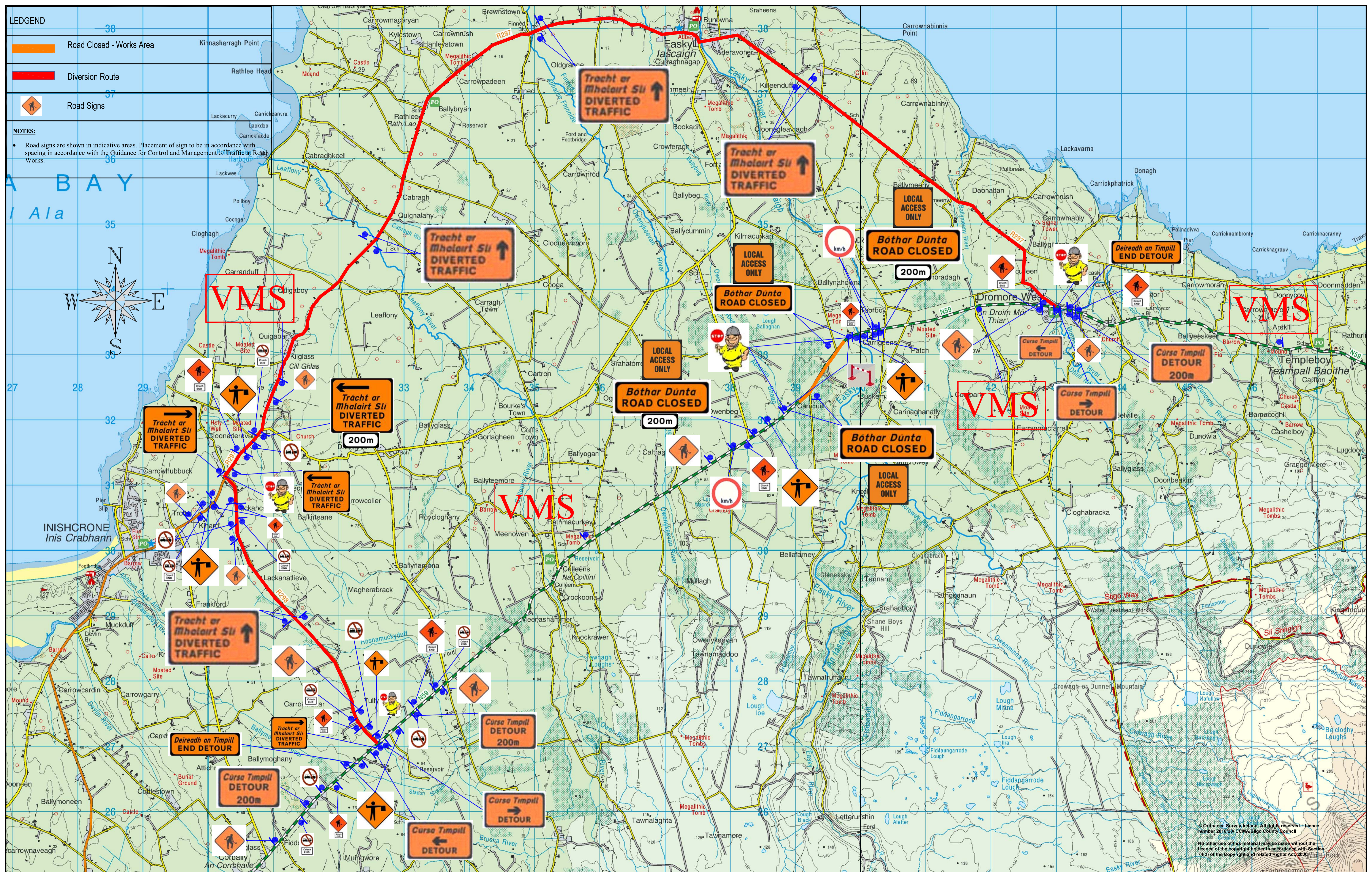
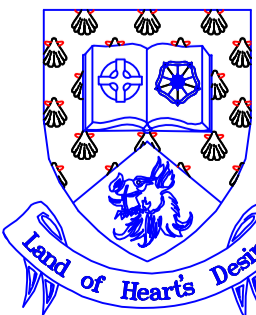

**LEDGEND**

- Road Closed - Works Area
- Diversion Route
- Road Signs

**NOTES:**

- Road signs are shown in indicative areas. Placement of sign to be in accordance with spacing in accordance with the Guidance for Control and Management of Traffic at Road Works.

**SLIGO COUNTY COUNCIL**  
 Road Design Office, Market Yard, Sligo.  
 Tel : (071) 9111975 Fax : (071) 9111990



**TII**  
 Bonnagar Iompair Éireann  
 Transport Infrastructure Ireland

Sligo County Council  
 N59 Owenbeg Phase 2  
 Overlay 2018

Project N59 Owenbeg Phase 2 - Overlay 2018			
Title Proposed Traffic Diversion Via R297 & R298			
Scales Do Not Scale	Date January 2018	Filename R115	Drawing No.: R115-I-100-06-02
Design VC	Drawn VC	Checked JOF	